



(Optional ELU Control System and Wheel Package)

(Blower is required for use. Blower is sold separately)

The model #250A cellulose (thru-blower) machine is a workhorse thru-blower unit. This equipment provides a versatile heavy duty yet portable design for both the **do-it-yourself/rental** market and the **professional contractor**. A large, 3/4hp. drive motor powers the low profile agitators through the toughest cellulose fibers. The material slidegate and air vent control offers precise adjustment to the operator for all retro-sidewall and open blow applications.

MATERIAL PRODUCTION RATE

lbs/hr (kg/hr) ratings with 100ft (30.5m.) of 2 1/2" (6.4cm.) hose at 10ft. (3.1m.) elevation

MATERIAL	MACHINE w/309 blower - medium fan lbs/hr (kg/hr)
CELLULOSE	1000 (454)

Product density and variable blowing conditions will affect production rate.

FEATURES AND BENEFITS

Mechanical (Standard)

- Safety guards and hopper bars provide operator safety
- Removable hopper provides quick disassembly and reassembly for easy troubleshooting and maintenance
- Dual agitators (side by side) enhance the conditioning of fibers
- Adjustable material feedgate control gives accurate control of fiber feed
- 3/4hp Totally Enclosed Fan Cooled heavy duty motor w/manual thermal overload protection provides durable and reliable drive system
- Belt/pulley drive system allows for simple and easy maintenance
- Cord hanger and hand pendant holder allow for convenient storage of cords and hand pendant

Electrical (Optional)

- Operator safety/Hazard response features: pre-alarm buzzer, main disconnect/power interruption shutdown, emergency kill switch, manual override at machine with ELU
- 100ft.(30.5m.) remote control cord with 3 position switch give increased operator control of feed and blower (with remote control or ELU)
- Deluxe voltmeter is an indicator for low/high voltage protection of motor (with remote control or ELU)
- Multiple auxiliary convenience outlets allow for easy addition of accessory devices (i.e. wetting, wireless, pump systems) (with remote control or ELU)
- Overload protection on transformer and all motors providing complete protection of all electrical components

WEIGHT

175 lbs. (79 kg.) w/remote
196 lbs. (89 kg.) w/ELU

HOPPER CAPACITY

8 cu. ft. (.22 m³)

CE MARK CONFORMITY

See reverse side for more information.

POWER REQUIREMENT

single input, 15amp/120volt/60hz/(w/o remote)
double input, 15amps each/120volt/60hz/(w/remote)
(230volt/50hz available for export)

For blower information see Model #309 spec sheet.

DIMENSIONS

29"W x 25"D x 43"H
(74cm. W x 64cm. D x 109cm. H)

AVAILABLE: (See diagram below)

- 9" (22.9 cm.) standard two wheel package (Pneumatic) (Part # W-9-A)
- 10" (25.4 cm.) standard two wheel package (Hard) (Part # W-10)
- standard remote control system with 100 ft. (30.5 m.) of remote cord (U.S. only)
- ELU control system with 100 ft. (30.5 m.) of remote cord (U.S. & Overseas)
- loading tray for easy conveyance of fiber into hopper
- 230volt/50hz (for export) **CE** Mark Conformity includes: hopper with loading tray and ELU control system

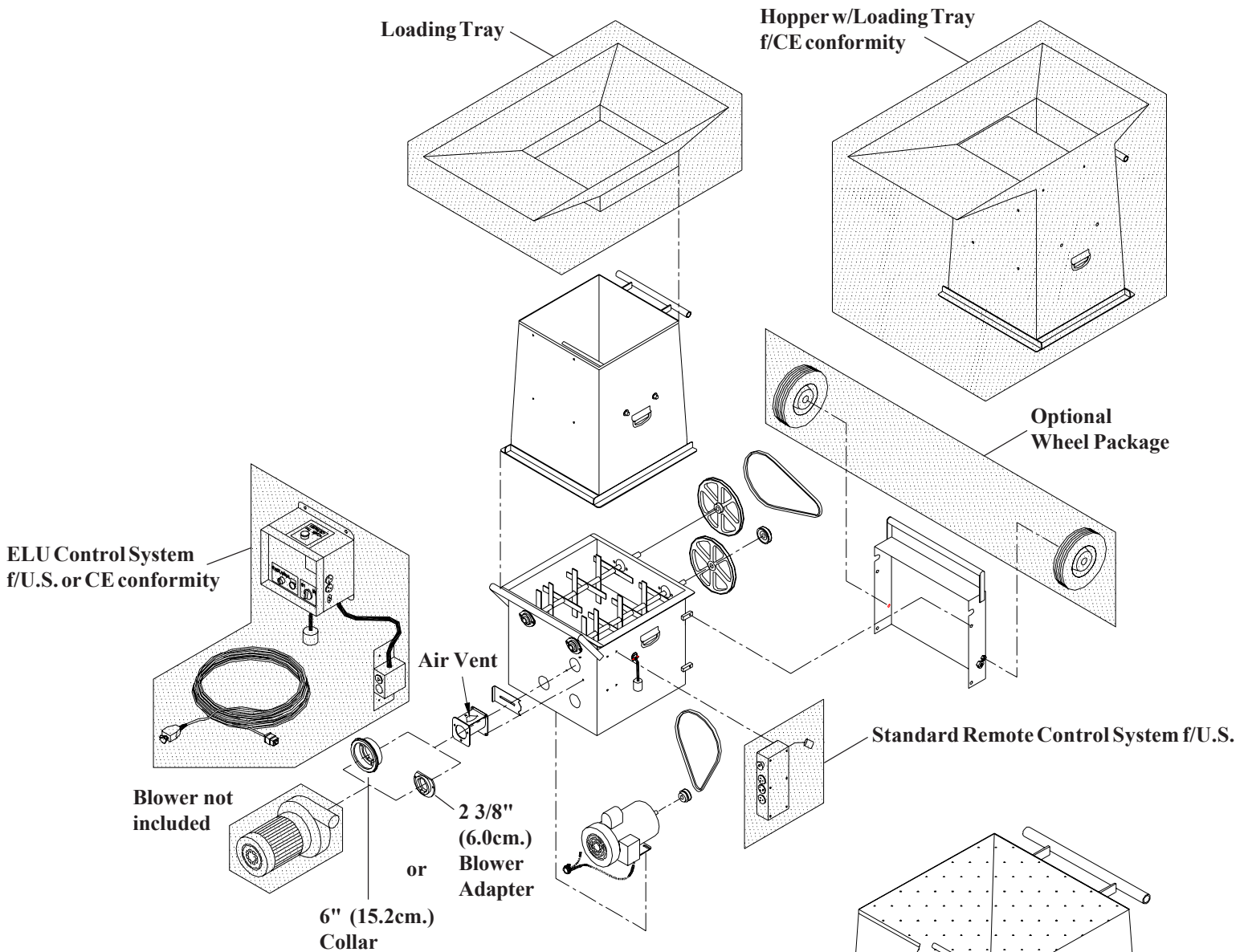

Modular components for easy replacement and repair

THRU-BLOWER MACHINE - THEORY OF OPERATION

(See diagram at right)

These units are designed to accept dry, non-abrasive (cellulose) fiber into the hopper area of the machine passing **through** the blower fan and chamber. The flow of fiber through the hose is controlled by a slidegate and an air vent opening adjacent to blower mount. The high speed (13,000 r.p.m.) conditioning effect of the blower fan provides unsurpassed performance in sidewall blowing and **coverage** in open attic blowing.

